

HIFG

Tenwek Cardiothoracic Hospital

# Designing for Healing in the Developing World



# Our Team



**David Wright, AIA, NCARB, ACHA**

*Chief Executive Officer*



**Connor Crist, AIA, NCARB, EDAC**

*Healthcare Architect*



***“ The design of this facility did not begin with blueprints or sketches, but with questions... What emerged was not simply a response to need, but a design shaped by listening and deep research. ”***



# Groundwork

## LISTENING FIRST

- + On-site interviews with doctors, nurses, staff & administrators
- + Patient and family interviews to understand lived experience
- + Studied cultural expectations around family presence during treatment & care priorities
- + Flow mapped patient recovery process; extended length of stay due to distance from hospital

# Tough Questions

## CHALLENGES & RESPONSE

- + We discovered there was limited access to construction materials & skilled labor
- + Material selection based on local climatic conditions, cost-effectiveness, & durability
- + Strategies for reliable power, water, and waste management
- + Designed for growth despite weak infrastructure & staff shortages





“

***...high-performing healthcare environments can be created even in low-resource settings when design is informed by rigorous research, local collaboration, and a commitment to salutogenic principles.***

”

# Holistic Healing



ENVIRONMENTAL



EMOTIONAL

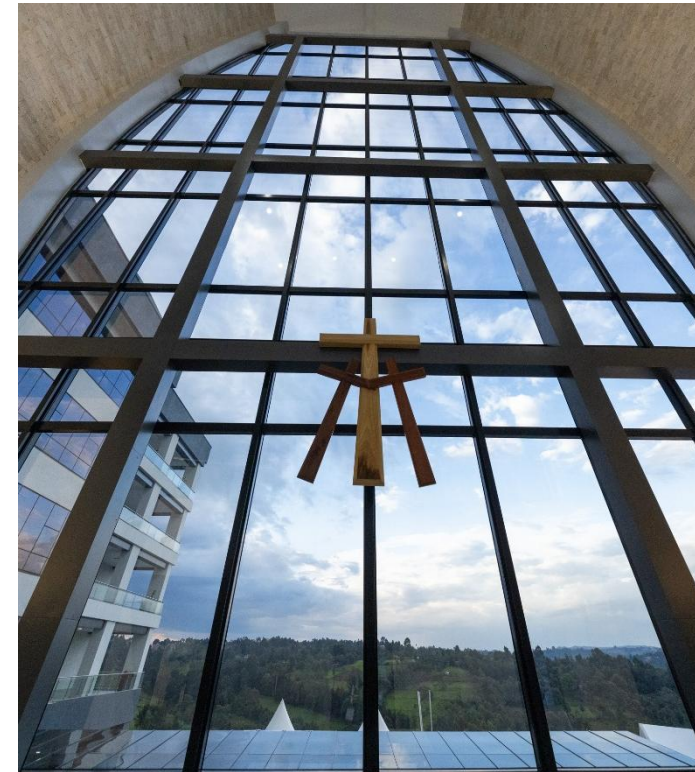

SPIRITUAL



OPERATIONAL



# Environmental

## SUSTAINABLE BY DESIGN

- + Rooftop solar panels provide reliable energy in power-scarce region
- + On-site rainwater collection & reuse
- + Wastewater treatment for long-term environmental health
- + Locally produced hollow-core concrete blocks reduced cost, increased durability
- + Natural ventilation supported by mechanical assistance in critical spaces

# Emotional

## HEALING THE HEART & MIND

- + Family-centered design prioritizes togetherness in healing
- + Biophilic design; murals of local landscape, local materials to support a sense of belonging
- + Views to nature & natural daylighting
- + Outdoor healing gardens & internal courtyard for recovery with direct access to nature





# Spiritual

## FAITH IN HEALING

- + Design reflects strong role of faith in Kenyan culture
- + Access to chapel & meditation space on every floor supports faith-based practices during patient care
- + Respect for diverse cultural & religious practices
- + Healing viewed as body, mind, & soul

# Operational

## FLOW OF CARE

- + Patient flow designed to support modern healthcare practices
- + Patient pods are an evolution of the Nightingale model to encourage family engagement & reduce isolation
- + Most vulnerable out of way from public flow – reducing noise, improving infection control, & promoting healing

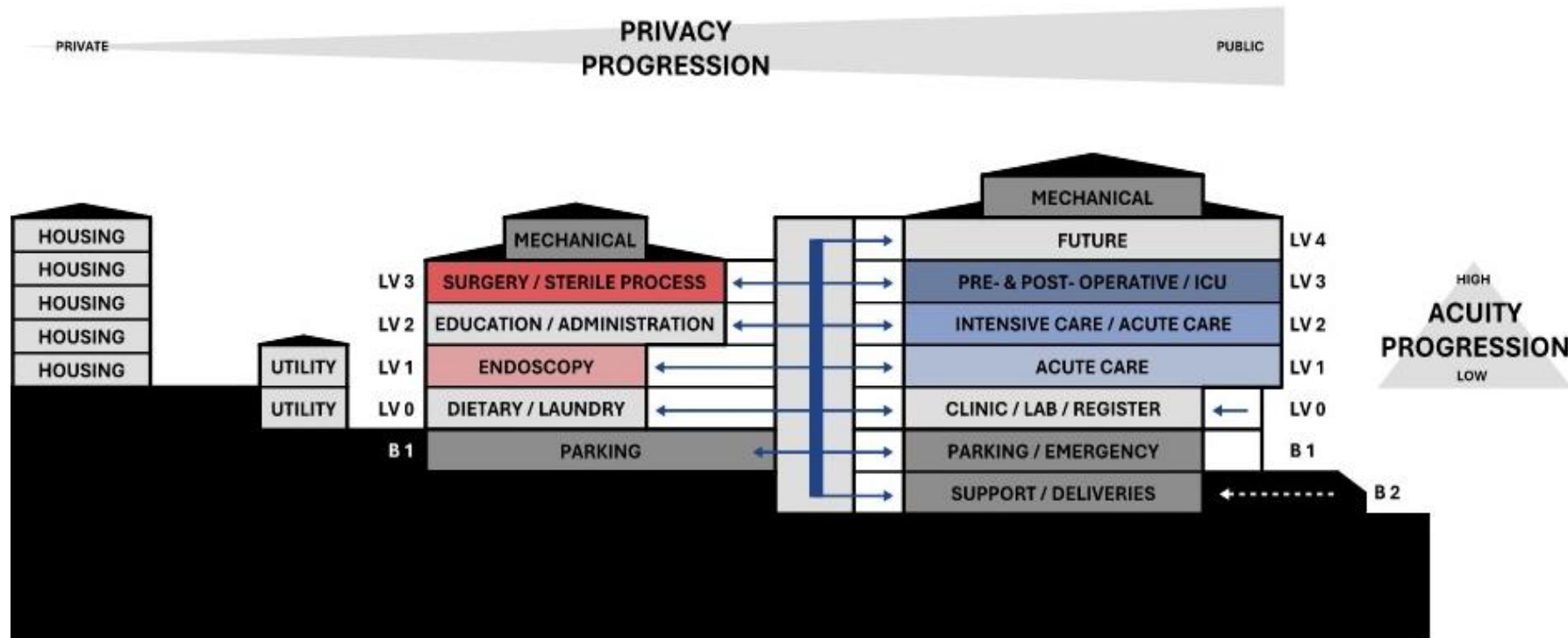
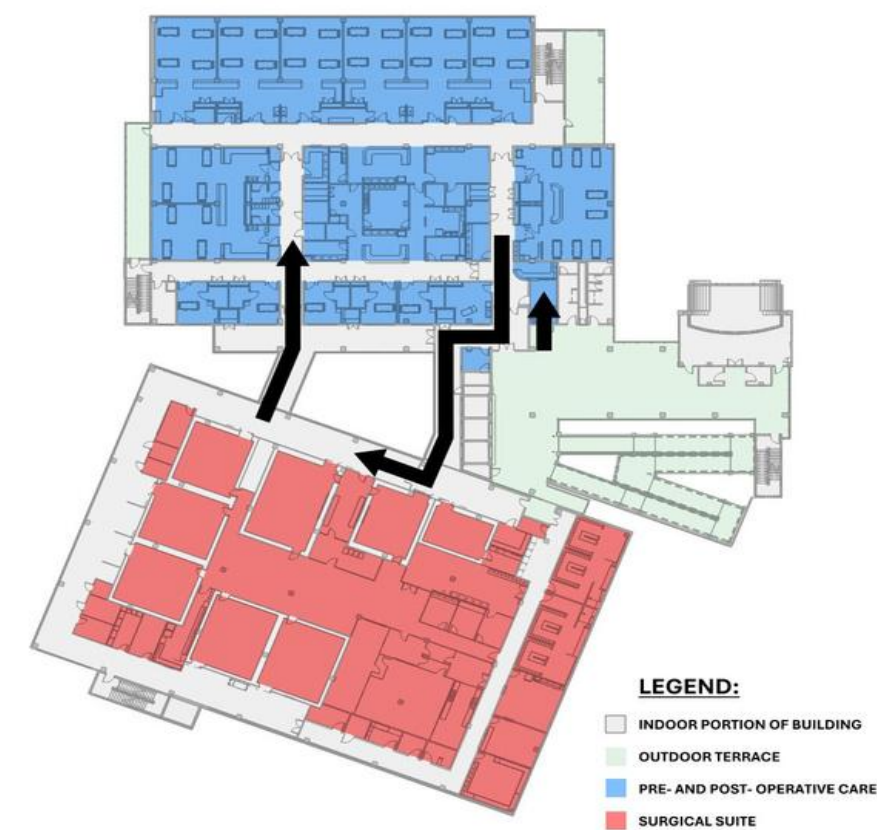



# Healing Beyond Walls

- + A hospital built for today and tomorrow
- + Rooted in research, culture, collaboration, & salutogenic design
- + Rethink healthcare design as a driver of wellbeing, not just treatment
- + Collaboration across cultures, disciplines, & borders
- + Commit to design that supports healing of mind, body, and spirit

*Let's Talk More*

